

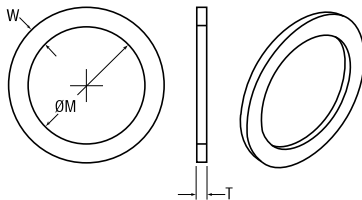

Back-Up Rings

Solid

(MS27595)



- Notes:**
1. Surfaces must be smooth and free from irregularities. Edges must be clean and sharp.
 2. Dimensions in inches.
 3. For use in packing grooves conforming to specifications MIL-Q-5514, not for use in O.D. (Piston) applications using MIL-P-5514 A & B glands.
 4. For single turn ring (cut) see MS 28774 (1F74).
 5. For extended sizes solid backup rings see T1745.
 6. Material: Tetrafluoroethylene, MIL-S-8791.

DASH NO.	ØM	ToL.	T	W	DASH NO.	ØM	ToL.	T	W	DASH NO.	ØM	ToL.	T	W
-004	0.080				-112	0.499				-139	2.192			
-005	0.111				-113	0.562				-140	2.254			
-006	0.125				-114	0.624				-141	2.317			
-007	0.156				-115	0.687				-142	2.379			
-008	0.187				-116	0.749	0.001			-143	2.442			
-009	0.219				-117	0.815				-144	2.504	0.002		0.089
-010	0.250				-118	0.877				-145	2.567			0.087
-011	0.312				-119	0.940				-146	2.629			
-012	0.375	0.001			-120	1.002				-147	2.692			
-013	0.440				-121	1.065				-148	2.754			
-014	0.503				-122	1.127				-149	2.817			
-015	0.565				-123	1.190				-210	0.753			
-016	0.628			0.056	-124	1.252				-211	0.815	0.001		
-017	0.690		0.052	0.054	-125	1.315		0.052	0.089	-212	0.878		0.052	0.048
-018	0.753		0.048		-126	1.377		0.048	0.087	-213	0.940			
-019	0.815				-127	1.440				-214	1.003			
-020	0.881				-128	1.502				-215	1.065			
-021	0.943				-129	1.565		0.002		-216	1.128			
-022	1.006				-130	1.629				-217	1.190			0.120
-023	1.068				-131	1.691				-218	1.253			0.118
-024	1.131				-132	1.754				-219	1.315			
-025	1.193		0.002		-133	1.816				-220	1.378	0.002		
-026	1.256				-134	1.879				-221	1.440			
-027	1.318				-135	1.942				-222	1.503			
-028	1.381				-136	2.004				-223	1.629			
-110	0.374			0.089	-137	2.067				-224	1.754			
-111	0.437	0.001		0.087	-138	2.129				-225	1.880			

Back-Up Rings

Solid

DASH NO.	ØM	Tol.	T	W	DASH NO.	ØM	Tol.	T	W	DASH NO.	ØM	Tol.	T	W
-226	2.005				-331	2.248				-434	5.627			
-227	2.130				-332	2.373				-435	5.752			
-228	2.255				-333	2.498				-436	5.877			
-229	2.380				-334	2.623				-437	6.002			
-230	2.505				-335	2.748				-438	6.252			
-231	2.630				-336	2.873				-439	6.502			
-232	2.755				-337	2.998				-440	6.752	0.002		
-233	2.880				-338	3.230				-441	7.002			
-234	3.005				-339	3.248				-442	7.252			
-235	3.130				-340	3.373		0.075 0.071	0.186 0.184	-443	7.502			
-236	3.255		0.052 0.048	0.120 0.118	-341	3.498				-444	7.752			
-237	3.380				-342	3.623				-445	8.002			
-238	3.505				-343	3.748				-446	8.502			
-239	3.630	0.002			-344	3.873	0.002			-447	9.002		0.110 0.106	0.237 0.235
-240	3.755				-345	3.998				-448	9.502	0.003		
-241	3.880				-346	4.123				-449	10.002			
-242	4.005				-347	4.248				-450	10.502			
-243	4.130				-348	4.373				-451	11.002			
-244	4.255				-349	4.498				-452	11.502			
-245	4.380				-425	4.502				-453	12.002	0.004		
-246	4.505				-426	4.627				-454	12.502			
-247	4.630				-427	4.752				-455	13.002			
-325	1.497				-428	4.877				-456	13.502			
-326	1.622				-429	5.002		0.110 0.106	0.237 0.235	-457	14.002			
-327	1.748		0.075 0.071	0.186 0.184	-430	5.127				-458	14.502	0.005		
-328	1.873				-431	5.252				-459	15.002			
-329	1.998				-432	5.377				-460	15.502			
-330	2.123				-433	5.502								



**Seal & Design
Corporate Headquarters**

Ph: (716)-759-3344

Info@SealAndDesign.com

www.SealAndDesign.com